

KRAIBURG maxiBOX

Prerequisites:



Concrete area:

- Approx. 10 cm high
- No holes
- No ridges
- Min. 3% slope

Rubber flooring and connecting bars:

Even temperature:
min. 5°C to max. 30°C
(store according to initial temperature)

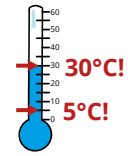

You will need:

Measuring:

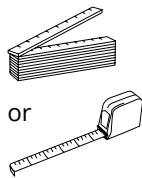

Marking:

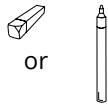

Cutting:

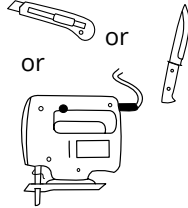

Drilling and installing:

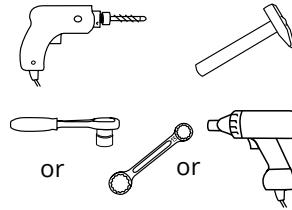

KRAIBURG fixings:

- Framing plugs \varnothing 10 x 100 mm with
 - Hexagon screws (AF 13) - A2
 - Washers \varnothing 30 mm - A2
 - Framing plugs \varnothing 10 x 135 mm with
 - Hexagon screws (AF 13) - A2
 - Washers \varnothing 30 mm - A2
- (Fixings are part of the delivery)

Complete system:

Front bar
(maxiBOARD)

Rear bar
(maxiSTEP)

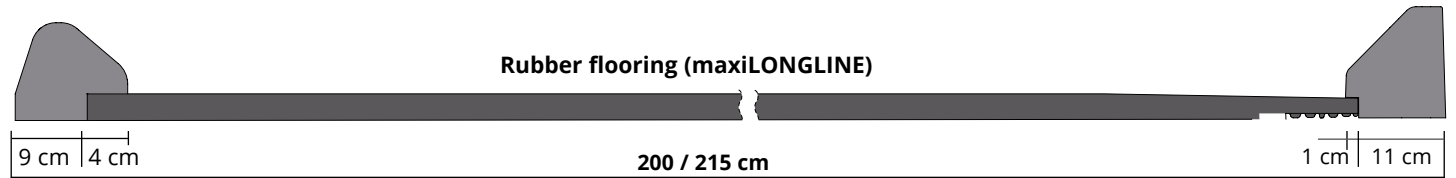

1 Roll out and position rubber flooring

Drainage openings towards the rear concrete edge

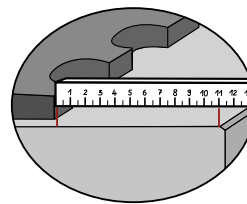
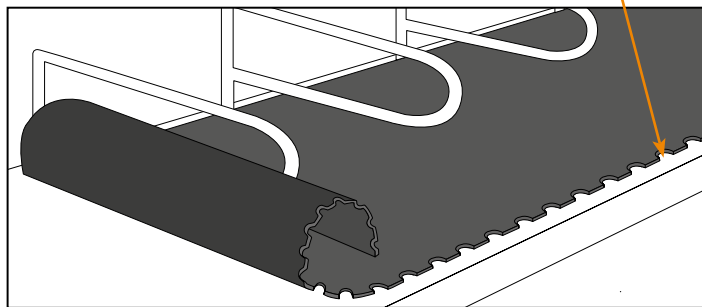

Rear concrete edge:
11 cm distance!

2 Position all maxiBOARDS and maxiSTEPS

Interconnect the connecting bars and position them loosely flush with the edge of the mat

maxiBOARD
(at front):

maxiSTEP (at rear):

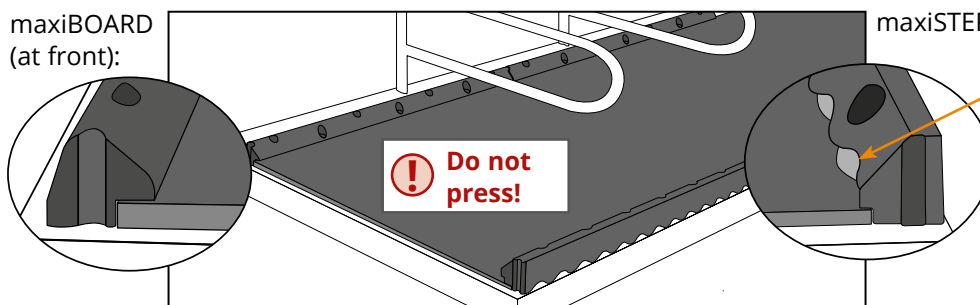

Position in such a way that the pockets in the connecting bar match the pockets in the rubber flooring to ensure openings are created (important for drainage)



3 Fix maxiBOARD and maxiSTEP

Fix at the pre-fabricated fixing points:

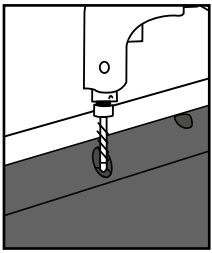

Drill

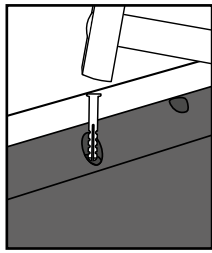

Knock the plastic plugs in flush

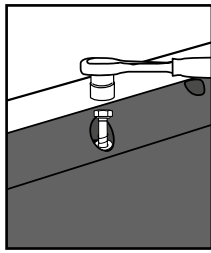

Tighten screws and washers until they are seated evenly and firmly.
Do not overtighten!



Framing plugs
ø 10 x 100 mm



Use every fixing hole!



Note:
Seal the drilled hole with the plug immediately after drilling (to prevent drilling dust entering the hole); only then drill the next hole.

4 Install maxiPROFIL XL (as a lateral lying area boundary or for closure of side edges)

Place the bar onto the rubber flooring and fix it

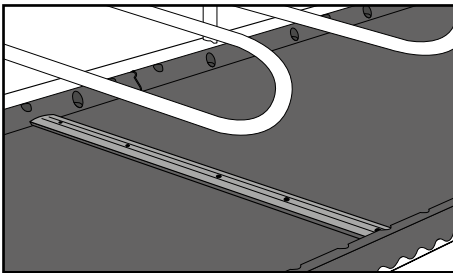

- Rounded off end on the rear edge
- Position rear flush between front and rear bar (maxiBOARD and maxiSTEP)



Framing plugs
ø 10 x 135 mm



Use every fixing hole!



Tip:
Avoid slippage:

- Fix at one fixing point
- Then drill further holes, etc.

With mushroom dividers:

i **Tip:** Possibly divide the rubber flooring (e.g. 5 – 6 m) to facilitate installation

5 Adapt

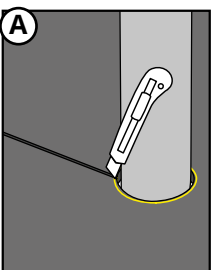

Cut rubber flooring to fit



Tips for cutting:

- Moisten the blade slightly
- Pull mat parts apart slightly

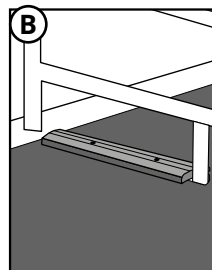

Cover the joints completely by dividing, adapting and fixing maxiPROFIL XL, if necessary, insert **additional fixing(s)** into the bar



A handsaw or a handheld circular saw is suitable for adapting the bars.

6 Fill with approx. 3 – 5 cm bedding (long straw, chopped straw, milled straw pellets, ...)